

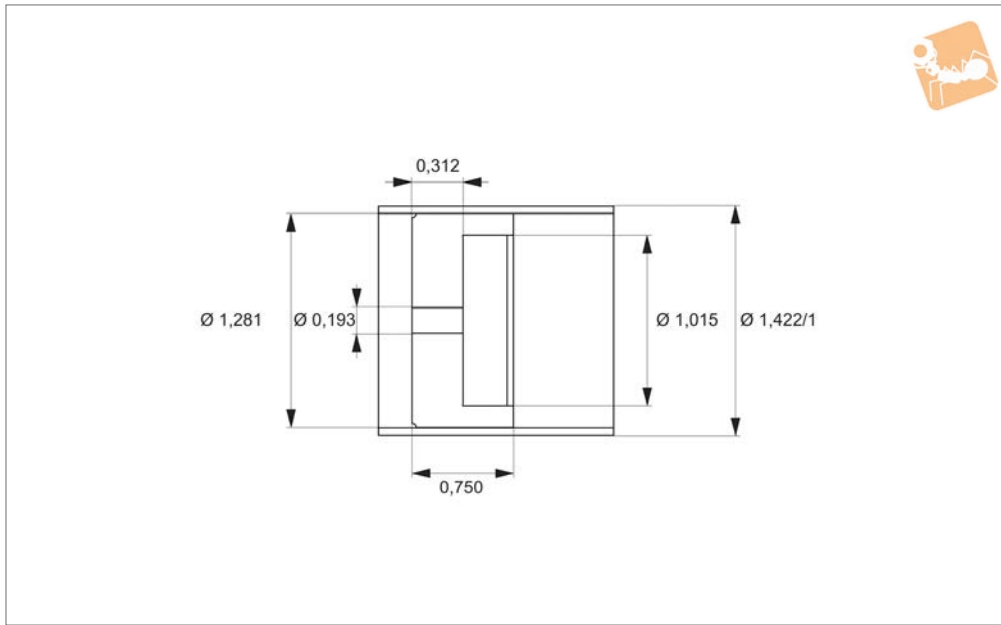

Cylinder / Piston Set

1,281" bore

Cylinders



L4638

CYLINDERS

Material

Piston: Carbon graphite
Cylinder: Glass

Technical Notes

Max operating temp = 260°C

Important Notes

Specials available on request.

Order No.	Stroke	Bore dia.	Outside dia.	Cylinder length	Piston length	Piston area in ²	Friction W/O sideload g	Cylinder weight g	Piston weight g
L4638.0500	0,5"	1.281	1.456	1,350"	0.750	1.289	< 1	13.82	17.75
L4638.1000	1,0"	1.281	1.456	1,850"	0.750	1.289	< 1	13.82	17.75
L4638.2000	2,0"	1.281	1.456	2,850"	0.750	1.289	< 1	13.82	17.75
L4638.3000	3,0"	1.281	1.456	3,850"	0.750	1.289	< 1	13.82	17.75
L4638.4000	4,0"	1.281	1.456	4,850"	0.750	1.289	< 1	13.82	17.75
L4638.5000	5,0"	1.281	1.456	5,850"	0.750	1.289	< 1	13.82	17.75
L4638.6000	6,0"	1.281	1.456	6,850"	0.750	1.289	< 1	13.82	17.75
L4638.7000	7,0"	1.281	1.456	7,850"	0.750	1.289	< 1	13.82	17.75
L4638.8000	8,0"	1.281	1.456	8,850"	0.750	1.289	< 1	13.82	17.75