

Plastic Levelling Feet

steel stud

Levelling Feet

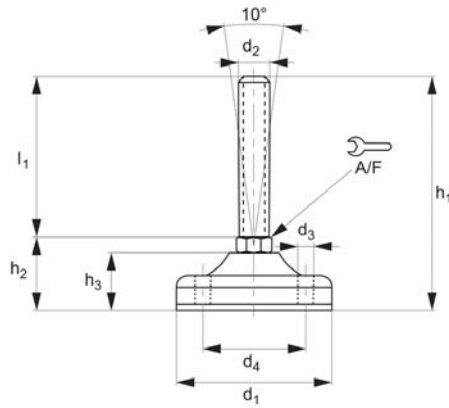

P2206

LEVELLING FEET

Material

Black plastic base (reinforced with fibre glass), with steel (C40) stud.

Technical Notes

Load values refer to static loads, located at half the screw height.

Order No.	d ₁	d ₂	d ₃	d ₄	l	h ₁	h ₂	h ₃	A/F
P2206.083-10-050	83	M10	8.5	56	50	89	39	31	16
P2206.083-10-075	83	M10	8.5	56	75	114	39	31	16
P2206.083-10-100	83	M10	8.5	56	100	139	39	31	16
P2206.083-10-125	83	M10	8.5	56	125	164	39	31	16
P2206.083-12-050	83	M12	8.5	56	50	89	39	31	16
P2206.083-12-075	83	M12	8.5	56	75	114	39	31	16
P2206.083-12-100	83	M12	8.5	56	100	139	39	31	16
P2206.083-12-125	83	M12	8.5	56	125	164	39	31	16
P2206.083-14-050	83	M14	8.5	56	50	89	39	31	16
P2206.083-14-075	83	M14	8.5	56	75	114	39	31	16
P2206.083-14-100	83	M14	8.5	56	100	139	39	31	16
P2206.083-14-125	83	M14	8.5	56	125	164	39	31	16
P2206.083-14-150	83	M14	8.5	56	150	189	39	31	16
P2206.083-14-175	83	M14	8.5	56	175	215	39	31	16
P2206.083-16-050	83	M16	8.5	56	50	89	39	31	16
P2206.083-16-075	83	M16	8.5	56	75	114	39	31	16
P2206.083-16-100	83	M16	8.5	56	100	139	39	31	16
P2206.083-16-125	83	M16	8.5	56	125	164	39	31	16
P2206.083-16-150	83	M16	8.5	56	150	189	39	31	16
P2206.083-16-175	83	M16	8.5	56	175	214	39	31	16
P2206.083-16-200	83	M16	8.5	56	200	239	39	31	16
P2206.083-20-075	83	M20	8.5	56	75	118	43	31	17
P2206.083-20-100	83	M20	8.5	56	100	143	43	31	17
P2206.083-20-125	83	M20	8.5	56	125	168	43	31	17
P2206.083-20-150	83	M20	8.5	56	150	193	43	31	17
P2206.083-20-175	83	M20	8.5	56	175	218	43	31	17
P2206.083-20-200	83	M20	8.5	56	200	243	43	31	17
P2206.083-20-225	83	M20	8.5	56	225	268	43	31	17
P2206.103-16-050	103	M16	12.5	73	50	98	48	36	17
P2206.103-16-075	103	M16	12.5	73	75	123	48	36	17
P2206.103-16-100	103	M16	12.5	73	100	148	48	36	17
P2206.103-16-125	103	M16	12.5	73	125	173	48	36	17
P2206.103-16-150	103	M16	12.5	73	150	198	48	36	17
P2206.103-16-175	103	M16	12.5	73	175	223	48	36	17
P2206.103-16-200	103	M16	12.5	73	200	248	48	36	17

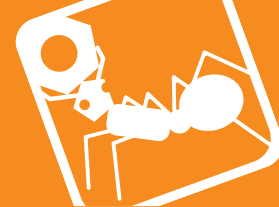

LEVELLING FEET

Order No.	d ₁	d ₂	d ₃	d ₄	l	h ₁	h ₂	h ₃	A/F
P2206.103-16-225	103	M16	12.5	73	225	273	48	36	17
P2206.103-20-075	103	M20	12.5	73	75	123	48	36	17
P2206.103-20-100	103	M20	12.5	73	100	148	48	36	17
P2206.103-20-125	103	M20	12.5	73	125	173	48	36	17
P2206.103-20-150	103	M20	12.5	73	150	198	48	36	17
P2206.103-20-175	103	M20	12.5	73	175	223	48	36	17
P2206.103-20-200	103	M20	12.5	73	200	248	48	36	17
P2206.103-20-225	103	M20	12.5	73	225	273	48	36	17
P2206.103-24-075	103	M24	12.5	73	75	125	50	36	20
P2206.103-24-100	103	M24	12.5	73	100	150	50	36	20
P2206.103-24-125	103	M24	12.5	73	125	175	50	36	20
P2206.103-24-150	103	M24	12.5	73	150	200	50	36	20
P2206.103-24-175	103	M24	12.5	73	175	225	50	36	20
P2206.103-24-200	103	M24	12.5	73	200	250	50	36	20
P2206.103-24-225	103	M24	12.5	73	225	275	50	36	20
P2206.123-16-050	123	M16	12.5	87	50	103	53	40	20
P2206.123-16-075	123	M16	12.5	87	75	128	53	40	20
P2206.123-16-100	123	M16	12.5	87	100	153	53	40	20
P2206.123-16-125	123	M16	12.5	87	125	178	53	40	20
P2206.123-16-150	123	M16	12.5	87	150	203	53	40	20
P2206.123-16-175	123	M16	12.5	87	175	228	53	40	20
P2206.123-16-200	123	M16	12.5	87	200	253	53	40	20
P2206.123-16-225	123	M16	12.5	87	225	278	53	40	20
P2206.123-20-075	123	M20	12.5	87	75	128	53	40	20
P2206.123-20-100	123	M20	12.5	87	100	153	53	40	20
P2206.123-20-125	123	M20	12.5	87	125	178	53	40	20
P2206.123-20-150	123	M20	12.5	87	150	203	53	40	20
P2206.123-20-175	123	M20	12.5	87	175	228	53	40	20
P2206.123-20-200	123	M20	12.5	87	200	253	53	40	20
P2206.123-20-225	123	M20	12.5	87	225	278	53	40	20
P2206.123-24-075	123	M24	12.5	87	75	128	53	40	20
P2206.123-24-100	123	M24	12.5	87	100	153	53	40	20
P2206.123-24-125	123	M24	12.5	87	125	178	53	40	20
P2206.123-24-150	123	M24	12.5	87	150	203	53	40	20
P2206.123-24-175	123	M24	12.5	87	175	228	53	40	20
P2206.123-24-200	123	M24	12.5	87	200	253	53	40	20
P2206.123-24-225	123	M24	12.5	87	225	278	53	40	20
P2206.123-24-250	123	M24	12.5	87	250	303	53	40	20
P2206.123-30-100	123	M30	12.5	87	100	153	53	40	26
P2206.123-30-125	123	M30	12.5	87	125	178	53	40	26
P2206.123-30-150	123	M30	12.5	87	150	203	53	40	26
P2206.123-30-175	123	M30	12.5	87	175	228	53	40	26
P2206.123-30-200	123	M30	12.5	87	200	253	53	40	26
P2206.123-30-225	123	M30	12.5	87	225	278	53	40	26
P2206.123-30-250	123	M30	12.5	87	250	303	53	40	26



All levelling feet can be produced with the following fixing types:

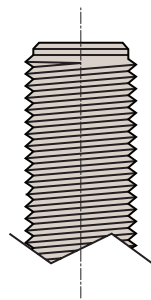
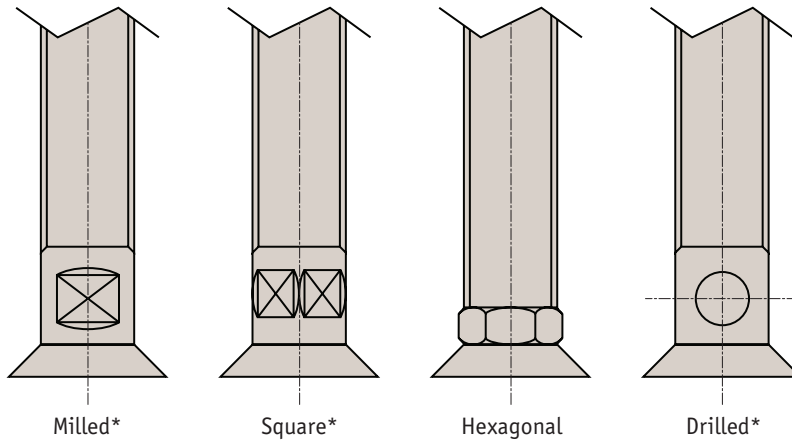
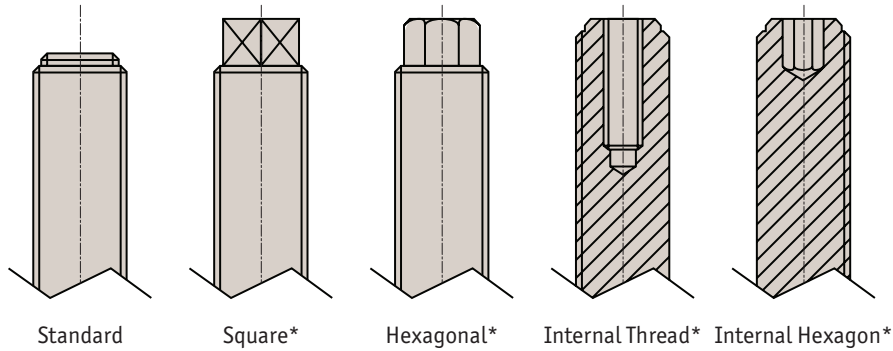

Thread versions

- Metric thread - coarse pitch (standard)
- Metric thread - fine pitch
- Thread gas 55°
- Imperial thread Unc
- Whitworth thread

* For non-standard threads a minimum order will apply.

Levelling Feet from Automotion Components

LEVELLING FEET