

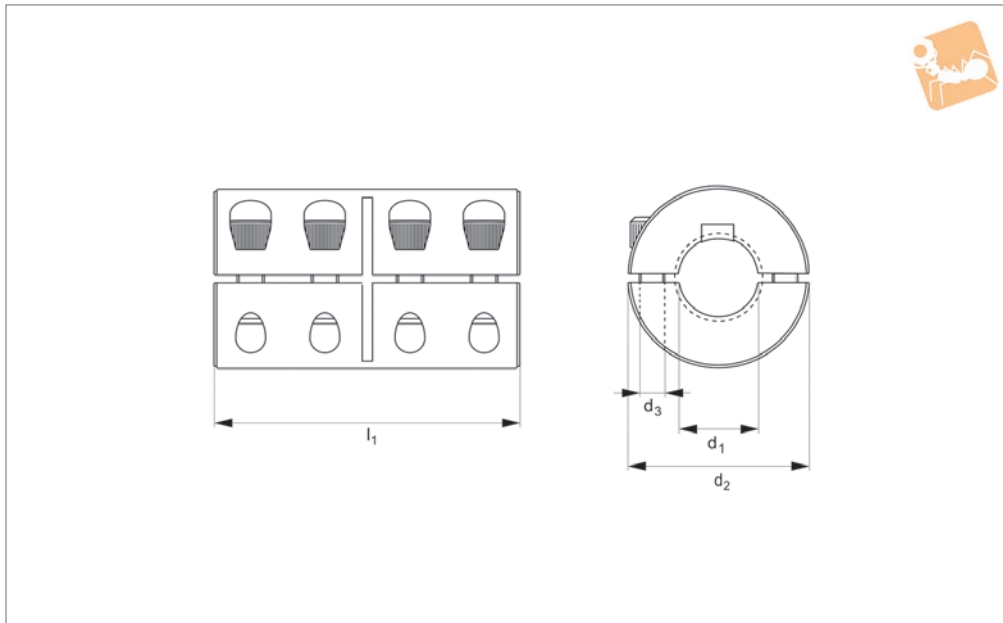

# Rigid Shaft Couplings - Two Piece

steel & stainless, clamping, long

## Rigid Couplings



**R3205**

RIGID COUPLINGS

### Material

Steel (AISI 12L14), black oxide finish, or stainless steel (A2, AISI 303).

High axial load and torque capacity.  
Part shown above with keyway.

See keyway technical pages.

### Technical Notes

To fit  $h_7$  or  $h_8$  tolerance shafts.

### Important Notes

Different bore sizes available on request.  
Keyways are standard to DIN 6885.

Order No.	$d_1$ tol. H7/H8	$d_2$ tol. H7/H8	$d_3$	$l_1$	Static torque Nm	Material	Type	Torque screw to Nm	Weight g	Weight g
R3205.060-BL	6	18	M 3	30	34	Steel	standard	2.0	40	40
R3205.080-BL	8	24	M 3	35	50	Steel	standard	2.0	80	80
R3205.100-BL	10	29	M 4	45	105	Steel	standard	4.5	190	190
R3205.120-BL	12	29	M 4	45	105	Steel	standard	4.5	180	180
R3205.140-BL	14	34	M 5	50	200	Steel	standard	9.5	250	250
R3205.150-BL	15	34	M 5	50	200	Steel	standard	9.5	240	240
R3205.160-BL	16	34	M 5	50	200	Steel	standard	9.5	230	230
R3205.200-BL	20	42	M 6	65	350	Steel	standard	16.5	500	500
R3205.250-BL	25	45	M 6	75	400	Steel	standard	16.5	620	620
R3205.300-BL	30	53	M 6	83	475	Steel	standard	16.5	1000	1000
R3205.350-BL	35	67	M 8	95	1100	Steel	standard	39.0	1100	1100
R3205.400-BL	40	77	M 8	108	1325	Steel	standard	39.0	2500	2500
R3205.500-BL	50	85	M10	124	2250	Steel	standard	78.0	3100	3100
R3205.080-BL-K	8	24	M 3	35	50	Steel	with keyway	2.0	80	80
R3205.100-BL-K	10	29	M 4	45	105	Steel	with keyway	4.5	190	190
R3205.120-BL-K	12	29	M 4	45	105	Steel	with keyway	4.5	180	180
R3205.140-BL-K	14	34	M 5	50	200	Steel	with keyway	9.5	240	240
R3205.150-BL-K	15	34	M 5	50	200	Steel	with keyway	9.5	240	240
R3205.160-BL-K	16	34	M 5	50	200	Steel	with keyway	9.5	230	230
R3205.200-BL-K	20	42	M 6	65	350	Steel	with keyway	16.5	500	500
R3205.250-BL-K	25	45	M 6	75	400	Steel	with keyway	16.5	620	620
R3205.300-BL-K	30	53	M 6	83	475	Steel	with keyway	16.5	1000	1000
R3205.350-BL-K	35	67	M 8	95	1100	Steel	with keyway	39.0	1100	1100
R3205.400-BL-K	40	77	M 8	108	1325	Steel	with keyway	39.0	2500	2500
R3205.500-BL-K	50	85	M10	124	2250	Steel	with keyway	78.0	3100	3100
R3205.060-A2	6	18	M 3	30	10	Stainless	standard	1.0	40	40
R3205.080-A2	8	24	M 3	35	16	Stainless	standard	1.0	80	80
R3205.100-A2	10	29	M 4	45	32	Stainless	standard	2.5	190	190
R3205.120-A2	12	29	M 4	45	32	Stainless	standard	2.5	180	180
R3205.140-A2	14	34	M 5	50	60	Stainless	standard	5.0	250	250
R3205.150-A2	15	34	M 5	50	60	Stainless	standard	5.0	240	240
R3205.160-A2	16	34	M 5	50	60	Stainless	standard	5.0	230	230



Order No.	d <sub>1</sub> tol. H7/H8	d <sub>2</sub> tol. H7/H8	d <sub>3</sub>	l <sub>1</sub>	Static torque Nm	Material	Type	Torque screw to Nm	Weight g	Weight g
<b>R3205.200-A2</b>	20	42	M 6	65	110	Stainless	standard	8.5	500	500
<b>R3205.250-A2</b>	25	45	M 6	75	120	Stainless	standard	8.5	620	620
<b>R3205.300-A2</b>	30	53	M 6	83	150	Stainless	standard	8.5	1000	1000
<b>R3205.350-A2</b>	35	67	M 8	95	330	Stainless	standard	20.5	1100	1100
<b>R3205.400-A2</b>	40	77	M 8	108	400	Stainless	standard	20.5	2500	2500
<b>R3205.500-A2</b>	50	85	M10	124	675	Stainless	standard	41.5	3100	3100
<b>R3205.080-A2-K</b>	8	24	M 3	35	16	Stainless	with keyway	1.0	80	80
<b>R3205.100-A2-K</b>	10	29	M 4	45	32	Stainless	with keyway	2.5	190	190
<b>R3205.120-A2-K</b>	12	29	M 4	45	32	Stainless	with keyway	2.5	180	180
<b>R3205.140-A2-K</b>	14	34	M 5	50	60	Stainless	with keyway	5.0	240	240
<b>R3205.150-A2-K</b>	15	34	M 5	50	60	Stainless	with keyway	5.0	240	240
<b>R3205.160-A2-K</b>	16	34	M 5	50	60	Stainless	with keyway	5.0	230	230
<b>R3205.200-A2-K</b>	20	42	M 6	65	110	Stainless	with keyway	8.5	500	500
<b>R3205.250-A2-K</b>	25	45	M 6	75	120	Stainless	with keyway	8.5	620	620
<b>R3205.300-A2-K</b>	30	53	M 6	83	150	Stainless	with keyway	8.5	1000	1000
<b>R3205.350-A2-K</b>	35	67	M 8	95	330	Stainless	with keyway	20.5	1100	1100
<b>R3205.400-A2-K</b>	40	77	M 8	108	400	Stainless	with keyway	20.5	2500	2500
<b>R3205.500-A2-K</b>	50	85	M10	124	675	Stainless	with keyway	41.5	3100	3100