

Ball and Socket Joints with sealing cap

Ball & Socket Joints

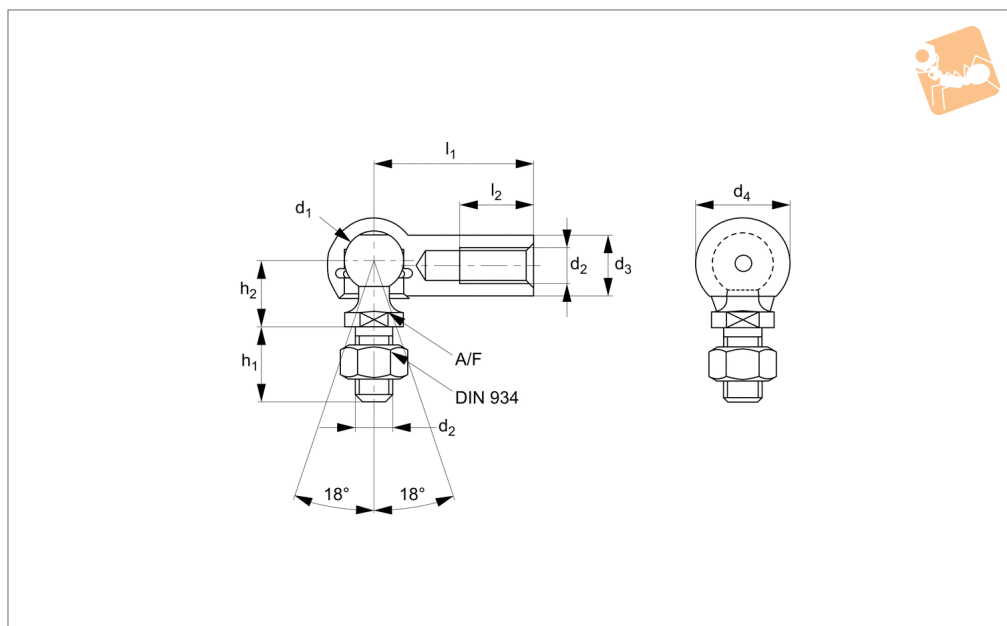

R3470

BALL & SOCKET JOINTS

Material

Steel, silver zinc plated, ball stud: steel minimum tensile strength $R_m=600N/mm^2$.
Housing: steel minimum tensile strength $R_m=500N/mm^2$, sealing cap: neoprene.

hexagon nut.

Safety ring aids the retention of the ball stud in the housing.

*M14x1,5 is a fine pitch thread.

Important Notes

Thread is not full length. There is a min 1.5mm unthreaded shank. If using part without the supplied nut, then please consider a counterbore to accommodate the unthreaded shank.

Technical Notes

To DIN 71802 form CS, supplied with

Tips

Standard thread is right hand, (for left hand thread see R3471).

Order No.	Thread hand	d ₁	l ₁ ±0.3	d ₂	d ₃	d ₄	h ₁ ±0.3	Weight g
R3470.R005	Right	8	22	M 5	8	12.8	10.2	15.2
R3470.R006	Right	10	25	M 6	10	14.8	12.5	25.2
R3470.R008	Right	13	30	M 8	13	19.3	16.5	53.1
R3470.R010	Right	16	35	M10	16	24.0	20.0	103.8
R3470.R012	Right	16	35	M12	16	24.0	20.0	103.8
R3470.R014	Right	19	45	M14x1,5*	22	30.0	28.0	220.9
R3470.R015	Right	19	45	M14	22	30.0	28.0	220.9
R3470.R016	Right	19	45	M16	22	30.0	28.0	220.9

Order No.	h ₂ ±0.3	l ₂ min.	A/F tol. h14	Extraction force kg min.	Static load kg max.	Dyn. load C kg max.	Force required for movement kg max.
R3470.R005	9	10.2	7	3	50	20	3
R3470.R006	11	11.5	8	4	100	40	4
R3470.R008	13	14.0	11	6	200	80	6
R3470.R010	16	15.5	13	8	400	160	8
R3470.R012	16	15.5	13	8	400	160	8
R3470.R014	22	21.5	16	10	800	320	10
R3470.R015	22	21.5	16	10	800	320	10
R3470.R016	22	21.5	16	10	800	320	10